

# MILK SILO (CAP: 20,000 - 100,000 LTR)

## MOC

INNER SHELL:	5/4/3/2	MM SS 304
OUTER JACKET:	2	MM SS 304
TOP CONICAL :	5/4/3	MM SS 304
BOTTOM FLAT :	5/4/3	MM SS 304

NOTE- CAN ALSO BE SUPPLIED WITH SS 316

## TECHNICAL DATA

	INNER SHELL PRESSURE (BAR)	OUTER JACKET PRESSURE (BAR)
TEST	ATM	ATM
WORK	ATM	ATM

## INSULATION

CAPACITY (LTR)	TYPE	THICKNESS (MM)
20,000	ROCK WOOL	100
30,000	ROCK WOOL	100
50,000	ROCK WOOL	100
1,00000	ROCK WOOL	100

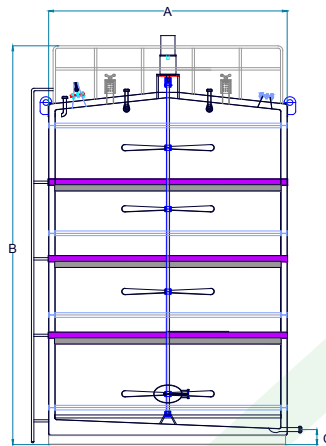
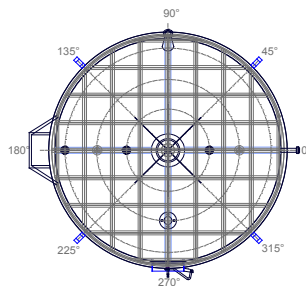

## NOZZLES & ACCESSORIES

PRODUCT INLET	51 /65 MM	SMS UNION
PRODUCT OUTLET	51 /65 MM	AS PER REQ.

## ACCESSORIES

MAN HOLE*	CIP
AIR VENT*	THERMOWELL
LIGHT GLASS	
SIGHT GLASS	

## AGITATOR , MOTOR DATA

## OVER ALL DIMENSIONS (MM)

CAPACITY (LTR)	MOTOR POWER (HP)	GEAR BOX MODEL	AGITATOR SPEED (RPM)	A	B	C	SHELL -ID	SHELL -HEIGHT
20,000	5/7.5	ALM-130	40	3120	4980	200	2900	3200
30,000	7.5/10	ALM-130	40	3220	6230	200	3000	4500
50,000	10/15	-	40	3875	6520	250	3650	5000
1,00000	10/15/20	-	40	4212	10263	250	4000	8750

## OPTIONS

- \* SPEED OF AGITATOR CAN ALSO CHANGE IF REQUIRED BY PROCESS CONDITIONS.

## ADDITIONAL ACCESSORIES

- \* LEVEL INDICATOR / SENSOR.
- \* TEMPERATURE INDICATOR AND SENSORS.